

Model TAL-250 Label Dispenser

TAKE-A-LABEL....

Providing Economical
Solutions in
Label Dispensing Systems

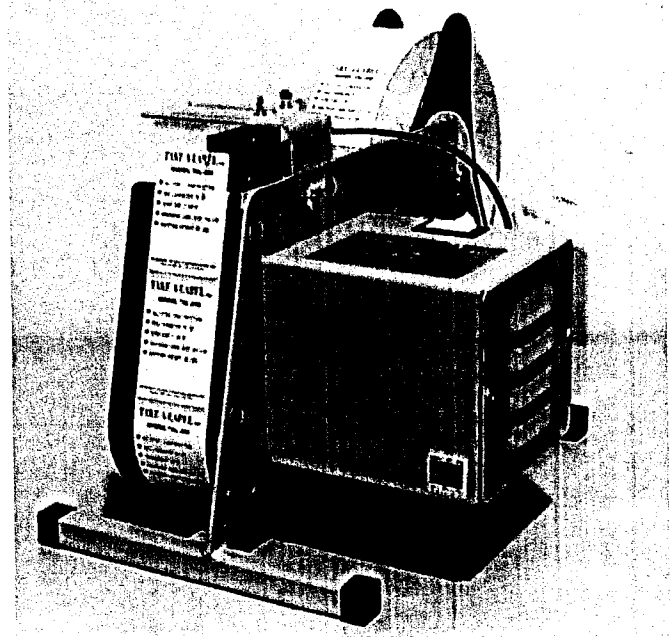

The TAKE-A-LABEL Model TAL-250 Using the 'standard' all steel and aluminum construction of the complete line, the Model TAL-250 provides the power and performance necessary for the most demanding applications.

The open peel plate design allows the user to run multiple labels on a common web to increase speed, while reducing label cost.

Standard Features

- ◇ Full Scrap Rewind with Quick Start / Removal Feature
- ◇ Label Roll Diameter up to 12"
- ◇ Durable All Steel Frame with Powder Coat Finish
- ◇ Heavy Duty Motor with Built In Overload Protection
- ◇ Dispenses Die-cut or Butt-cut Labels
- ◇ Dispenses Multiple Labels on a Common Web

Specifications

- ◇ Shipping Weight: 27 Lbs.
- ◇ Electrical Requirements: 110V AC
- ◇ Min. and Max. Liner Width: 3/8" to 2.75"
- ◇ Maximum Label Size: 2.5" x 10"
- ◇ Maximum Roll Diameter: 12"
- ◇ Core Size: 1" or 3" Diameter
- ◇ Unit Dimensions: W 13 1/4" x H 11" x L 17"

Optional Attachments

- ◇ Photo Cell Label Sensor
- ◇ Fan Fold Adapter
- ◇ Random Ink Imprinter

Model TAL-450 Label Dispenser

TAKE-A-LABEL....

Providing Economical
Solutions in
Label Dispensing Systems

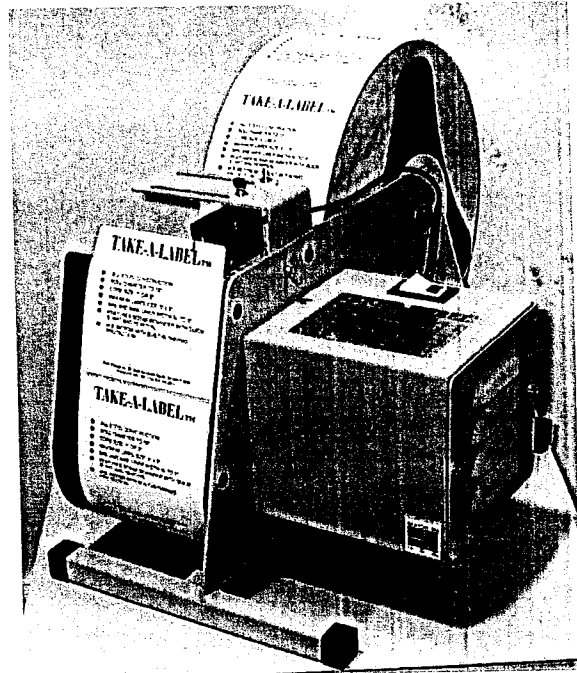

The TAKE-A-LABEL Model TAL-450 Using the 'standard' all steel and aluminum construction of the complete line, the Model TAL-450 provides the power and performance necessary for the most demanding applications.

The open peel plate design allows the user to run multiple labels on a common web to increase speed, while reducing label cost.

Standard Features

- ◇ Full Scrap Rewind with Quick Start / Removal Feature
- ◇ Label Roll Diameter up to 12"
- ◇ Durable All Steel Frame with Powder Coat Finish
- ◇ Heavy Duty Motor with Built In Overload Protection
- ◇ Dispenses Die-cut or Butt-cut Labels
- ◇ Dispenses Multiple Labels on a Common Web

Specifications

- ◇ Shipping Weight: 29 Lbs.
- ◇ Electrical Requirements: 110V AC
- ◇ Min. and Max. Liner Width: 3/8" to 4.5"
- ◇ Maximum Label Size: 4.5" x 10"
- ◇ Maximum Roll Diameter: 12"
- ◇ Core Size: 1" or 3" Diameter
- ◇ Unit Dimensions: W 13 1/4" x H 11" x L 17"

Optional Attachments

- ◇ Photo Cell Label Sensor
- ◇ Fan Fold Adapter
- ◇ Random Ink Imprinter

TAKE-A-LABEL, Inc.
Take-A-Label Dispenser Parts List
TAL-250 & 450 -

Item	Description	Part#
72615	Main frame	1
25109	Unwind shaft/250	2
45125	Unwind shaft/450	2
45136	Unwind disc	3
72618	Unwind bracket mtl.	4
25112	Unwind washer	5
25113	Unwind spring	6
26001	Unwind collar	7
26002	Unwind hub screw	8
25121	Hex nut/unwind shaft	16
25114	Waste wind shaft	9
45129	Waste wind shaft	9
25115	Waste wind clip/250	10
45131	Waste wind clip/450	10
25116	Stripping plate/250	11
45124	Stripping plate/450	11
25117	Motor control housing	12
25118	M/C housing end plate	13
25119	On/off switch	14
25120	Micro mounting bracket	15
76800	Gear motor	17
45217	Power cord	18
45153	Cord clamp	19
45155	Fuse holder	20
45157	Fuse	21
45207	Cherry switch	22
45208	Trip wire	23
45209	Label Switch	24
25122	Foot end caps	25
45180	Wing/nut 1/4 x 20	27
45181	Carriage bolt 1/4 x 20	28
45182	Nylon washer/micro mtg.	29
45183	Screw #10-32 x 1/2	30
45184	Nut #10-32 hex nylock	31
45210	Thumb screw 10/24 x 1/2	32
45242	Motor Brake Arm	33
25101	Brake Hammer	34

Terms are net 30 days

Prices are subject to change without notice

WHEN ORDERING PARTS, SPECIFY MODEL NUMBER OF YOUR MACHINE

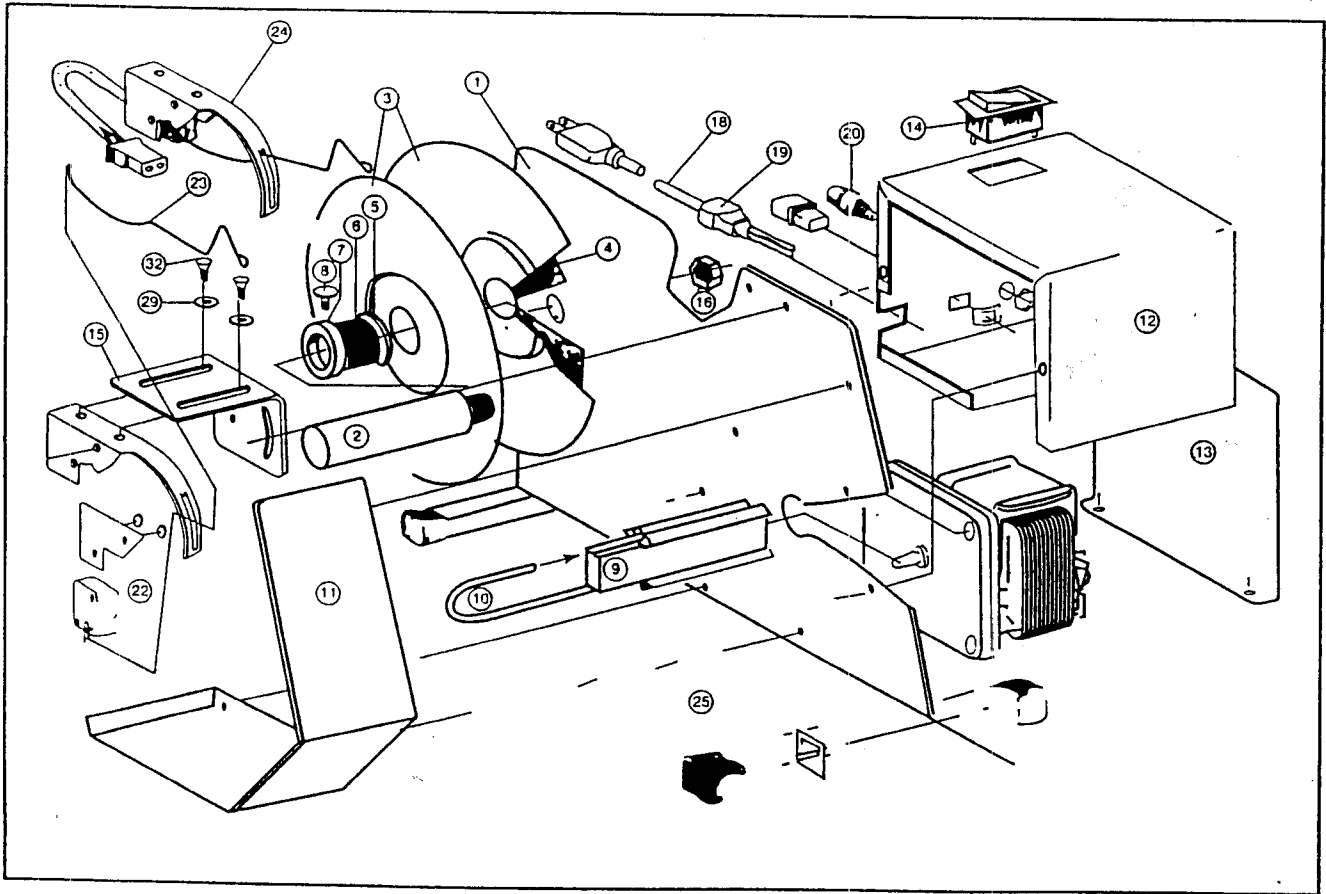

WARRANTY

The Take-a-Label is warranted to be free from defects in material and workmanship for 1 year from date of shipment. If such a defect occurs, the unit is to be returned immediately to the factory or representative as designated by the manufacturer. Neither manufacturer nor seller shall be liable for any loss or damage arising out of the use or inability to use this equipment.